

OKLAHOMA DEPARTMENT OF TRANSPORTATION				
FED. ROAD DIST. NO.	STATE	STATE JOB NO.	FISCAL YEAR	SHEET NO.
	OKLA	29289(04)		45
DESCRIPTION			REVISIONS	DATE

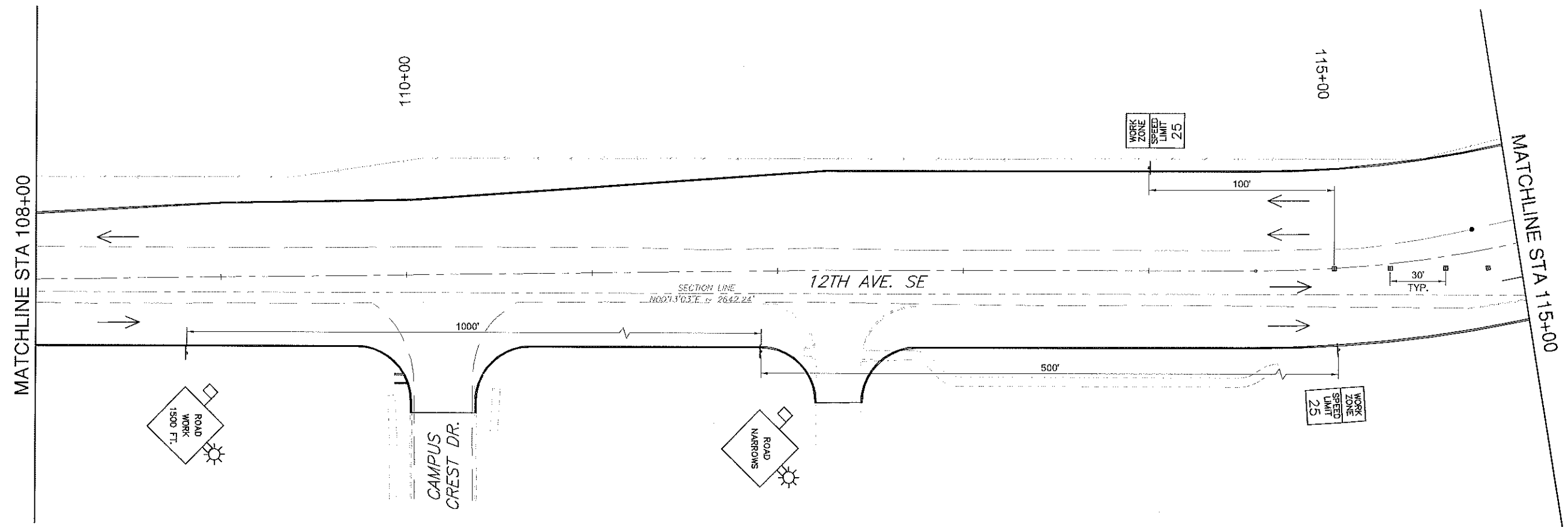

PHASE VI NOTE:

MILL AND OVERLAY INSIDE SH-9 LANES (BOTH EASTBOUND AND WESTBOUND) ON THE WEST SIDE OF THE INTERSECTION WITH 12TH AVE SE.

SH-9 SHALL REMAIN OPEN DURING CONSTRUCTION. THE CONTRACTOR SHALL BE RESPONSIBLE FOR PROPER BARRICADES, LIGHTS, AND SIGNING WITHIN THE LIMITS OF CONSTRUCTION. ALL CONSTRUCTION SIGNING WILL BE DONE ACCORDING TO STANDARDS SET FORTH IN THE MANUAL ON UNIFORM TRAFFIC CONTROL DEVICES, (CURRENT EDITION), AND AS SHOWN ON TCS STANDARD DRAWINGS.

LEGEND	
	WORK AREA
	SIGN
	DRUM
	PAVEMENT MARKER (YELLOW)
	TYPE III BARRICADE

DESIGN	SKC
DRAWN	Tl
CHECKED	SKC
APPROVED	MNR
SQUAD	Tl

OKLAHOMA DEPARTMENT OF TRANSPORTATION	
TRAFFIC CONTROL - PHASE VI	
STATE JOB NO. 29289(04)	SHEET NO. 45

2/16/2017 4:55:07 PM - P:\08512\13\13001\CAD\SHSHEET\ESTRAFFIC CONTROL\PLDING - RODRIGUEZ, AMY